



CROSSINGS — AT TRYON —

Lilac A1



1733 Sq Ft

3 Bed / 2.5 Bath / 1 Car Garage

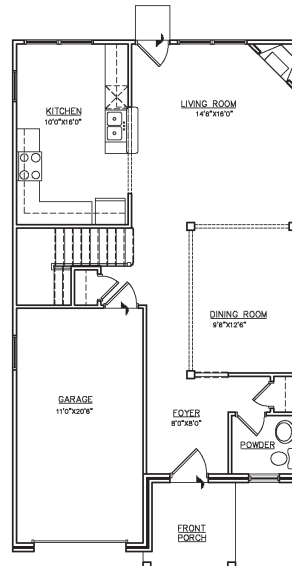
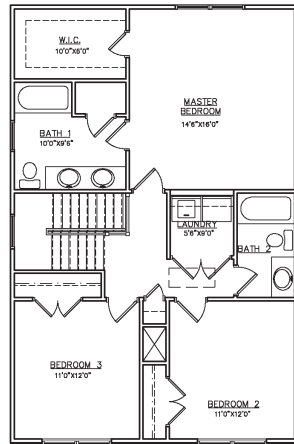

UNIT A1
1733 TOTAL HEATED SF
(INCLUDING 1ST & 2ND FLOOR STAIR AREA)
151 FLOOR BLANK
753 SF HEATED
54 SF FRONT PORCH
235 SF GARAGE
2ND FLOOR BLANK
900 SF HEATED

